

MANOMETRI SA KAPSULOM, RADIJALNI PRIKLJUČAK

pogodni za plinove, DN 63-80-100

CAPSULE PRESSURE GAUGES, BOTTOM CONNECTION

gas-specific version, DN 63-80-100

MP -- RM

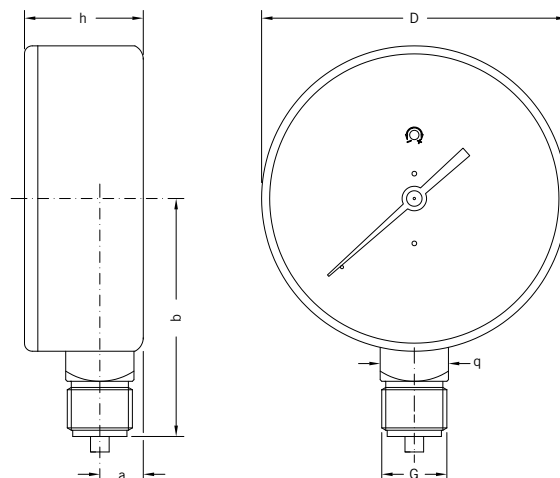

> DIMENZIJA I TEŽINA/ SIZES AND WEIGHTS

MODEL	D	G	q	a	b	h	TEŽINA/WEIGHT
MP 63 RM	63 mm	R1/4"	14x14 mm	11 mm	50 mm	31 mm	165 gr
MP 80 RM	80 mm	G3/8"	17x17 mm	12 mm	63 mm	32 mm	230 gr
MP 100 RM	100 mm	G1/2"	22x22 mm	14 mm	77 mm	38 mm	415 gr

> PRIMJENA

Manometri za mjerenje niskih tlakova (maksimalno 600 mbar). Posebno su pogodni za zapaljive plinove (metan, propan i slično) ili ostale nekorozivne za bakar i legure kositra.

> GRANE PRIMJENE

- distribucijske sustave u domaćinstvu i za pogonska goriva
- testovi za provjeru tlaka dovoda i uporabe plina
- industrijska i tehnička oprema

> APPLICATIONS

Pressure gauges for measuring low pressures (max. 600 mbar). Particularly suitable for combustible gases (methane, propane and similar) or other non-corrosive to copper and tin alloys.

> MAIN FIELDS OF APPLICATION

- domestic distribution systems and use of fuel gases
- tests to verify pressure supply and gas usage
- industrial and technical equipment

> NORMATIVI

- EN 837-1
klasa preciznosti 1,6
- direktiva CE 1997-23(PED)
- stupanj zaštite IP65 prema EN 60529

> NORMATIVE REFERENCES

- EN 837-3
1.6 precision class
- CE 1997-23 directive (PED)
- degree of protection IP31 according to EN 60529

> RADNA OPTEREĆENJA

Temperatura

Na manometru -40 ÷ +70 °C
Medij max 70 °C

Tlak

Do 3/4 cijele mjerne skale za statički tlak
Do 2/3 cijele mjerne skale za fluktuirajući tlak
Do cijele mjerne skale za kratke intervale

Fluidi

Tekućine ili plinovi koji nisu korozivni za legure bakra, niske viskoznosti i ne kristalizirajući
Manometri nisu pogodni za kisik

> OPERATING LIMITS

Temperatures

On the body of the pressure gauge -40 ÷ +70 °C
Of pressurized fluid max 70 °C

Pressure

Up to 3/4 of the full scale value for static pressures
Up to 2/3 of the full scale value for fluctuating pressure
Up to the full scale value for short periods

Fluids

Liquid or gaseous non-corrosive to copper alloys, not highly viscous, not crystallising
Gauges not suitable for oxygen

> **KONSTRUKCIJSKE KARAKTERISTIKE**

- sivo obojano čelično kućište
- prozor od kristalno čistog metakrilata
- bijeli aluminijski brojčanik
- crni tisak
- aluminijska kazaljka
- mesing priključak
- mjerni mehanizam: berilij- bakar membrana i mesing mehanizam (OT59)

> **CONSTRUCTION FEATURES**

- grey oven-painted steel case
- crystal clear methacrylate window
- prepainted aluminium white dial
- black graphics
- aluminium indicator
- brass coupling
- sensitive system: membrane in beryllium copper and brass alloy clockwork mechanism (OT59)

> **MODELI I CIJENE**

MP 63 RM

ŠIFRA	M.P./SCALE	€
914 062 01	40 mbar	31,90
914 062 02	60 mbar	31,10
914 062 03	100 mbar	31,10
914 062 04	160 mbar	31,10
914 062 05	250 mbar	31,10
914 062 06	400 mbar	31,10
914 062 07	600 mbar	31,10

MP 80 RM

ŠIFRA	M.P./SCALE	€
914 044 01	40 mbar	38,10
914 044 02	60 mbar	37,50
914 044 03	100 mbar	37,50
914 044 04	160 mbar	37,50
914 044 05	250 mbar	37,50
914 044 06	400 mbar	37,50
914 044 07	600 mbar	37,50

MP 100 RM

ŠIFRA	M.P./SCALE	€
914 015 01	40 mbar	42,70
914 015 02	60 mbar	42,10
914 015 03	100 mbar	42,10
914 015 04	160 mbar	42,10
914 015 05	250 mbar	42,10
914 015 06	400 mbar	42,10
914 015 07	600 mbar	42,10