

## BIMETALNI PIROMETAR, AKSIJALNA SONDA

mjerno područje 0/500°C sa staklenim prstenom, DN 63

## BIMETALLIC PYROMETERS WITH REAR STEM

0/500 °C scale with glass ring, DN 63

**PSZ 63 PR**

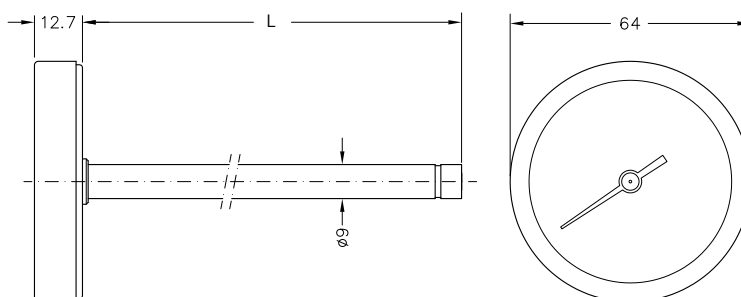

### > PRIMJENA

Bimetalni pirometar je čvrste konstrukcije, skale do 500°C. Posebno su pogodni za mjerenje temperature plinova ispušnih sustava. Mogu se ugraditi direktno preko sonde ili uz pomoć spirle i zaštitnog tuljka.

### > GRANE PRIMJENE

- ispušni sustavi
- pećnice
- kuhala
- ostala oprema za grijanje

### > APPLICATIONS

The bimetallic pyrometers, sturdy version, full scale 500 °C, are particularly suitable for measuring exhaust fumes from heaters. They can be attached to the application directly through the body or stem, or with the aid of an accessory as a lantern spring, pocket, or bracket (see accessories for thermometers pag. 59).

### > MAIN FIELDS OF APPLICATION

- smoke exhaust systems
- ovens
- stoves
- other equipment for heating

### > NORMATIVI

- UNI EN 13190  
klasa preciznosti 2
- stupanj zaštite IP31 prema EN 60529

### > NORMATIVE REFERENCES

- UNI EN 13190  
class precision 2
- degree of protection IP31 according to EN 60529

### > RADNA OPTEREĆENJA

Dopuštena temperatura na kućištu termometra  
-20/+90°C  
Tekućine ili plinovi koje nisu korozivne za bakrene legure

### > OPERATING LIMITS

Temperature allowed on the thermometer casing  
-20 ÷ +90 °C  
Liquid or gaseous fluids not corrosive for copper alloys

**> KONSTRUKCIJSKE KARAKTERISTIKE**

- kućište od galvaniziranog čelika
- čelični obruč
- prozirno staklo, debljine 2 mm
- obojani aluminijski brojčanik  
srebrna pozadina, crni tisak
- mesing sonda Ø 9 mm
- mjerni mehanizam: bimetalna spirala

**> CONSTRUCTION FEATURES**

- case in galvanized steel
- nickel-plated steel retaining ring
- transparent glass, thickness 2 mm
- prepainted aluminium dial  
silver background, black graphics
- brass piping stem Ø 9 mm
- movement: bimetallic spiral

**> MODELI I CIJENE**

**PSZ 63 PR**

ŠIFRA	(L) DULJINA/LENGTH	TEŽINA/WEIGHT	€
916 360 50	50 mm	65 gr	7,00
916 361 00	100 mm	80 gr	7,00
916 361 50	150 mm	91 gr	7,30
916 362 00	200 mm	102 gr	7,90
916 363 00	300 mm	124 gr	8,80

